

ST-Timber Cladding Accessories

Ventbat™ Structural Cavity Batten

Ventbat™ significantly enhances the performance of both vertical and horizontal cladding systems, especially when paired with Stagwood's KDHW and Thermory Cladding products.

Its castellated profile and sloped top are intelligently designed to promote ventilation and drainage which are key factors for long-term durability, water resistance and overall building protection.

By providing added structural support to external cladding, Ventbat™ also reinforces the stability of the building envelope.

It is H3 treated and fully compliant with construction standards offering weather resistance, dimensional consistency and compatibility for a wide range of cladding applications.

Features & Benefits

Name:	Ventbat™ Structural Cavity Batten
Barcode Number:	9339306004919
Certification:	This product is made of FSC®-certified and other controlled material
Structural Grade:	SG8/F7
Treatment:	H3 LOSP
Material:	H3 Treated Finger Jointed Radiata Pine
Batten Size:	70 x 35 x 2700mm Standard (70 x 35mm) fits typical construction sizes
Application:	For vertical and horizontal cladding on timber, masonry or steel structures
Installation/Compliance:	Fits up to N4/C2 wind zones at max 900mm spacing when face fixing. Compliant with drainage requirements of the National Construction Code.
Termites:	Resistant



Scan QR for
ST-Cladding Installation
Guide.

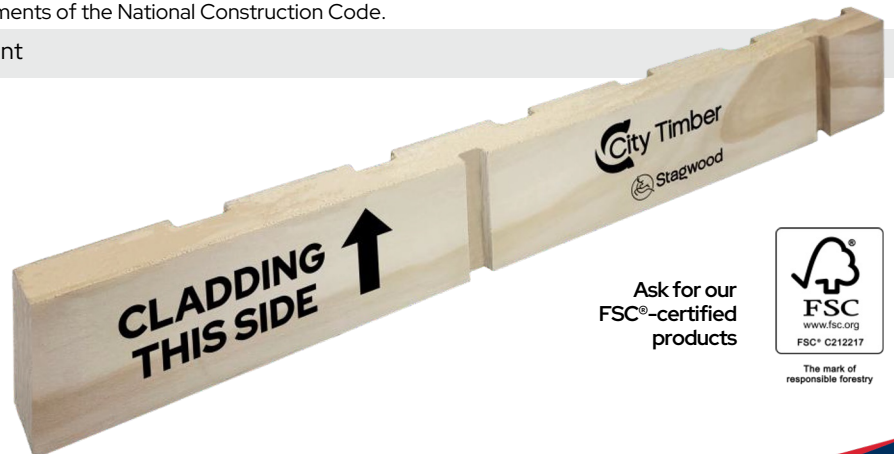

Ask for our
FSC®-certified
products



Ventbat™ Installation Steps

1. Ventbat™ Span

On walls 1200mm wide or less and up to 1800mm high, an extra batten must be added to extend the cladding span to three bays.

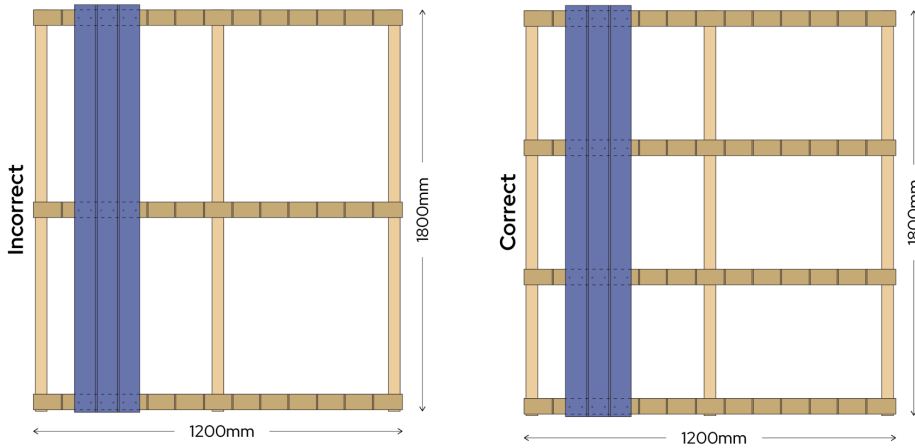

2. Install Sectional Diagram

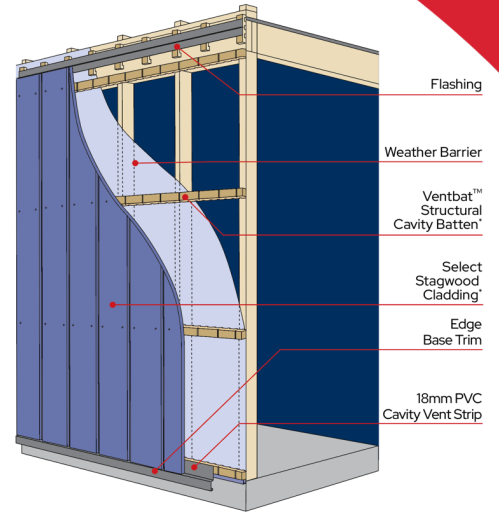

3. Install Around Windows

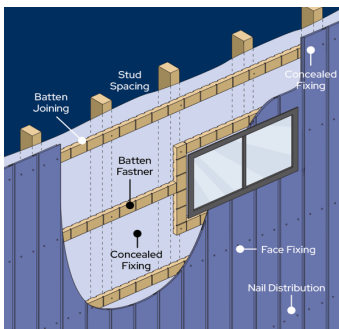

4. Install Cover Detail

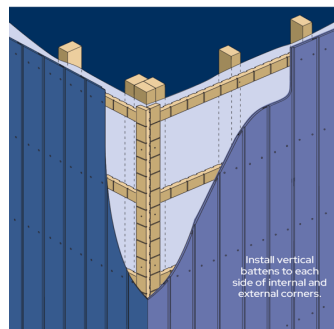

5. Install Horizontal

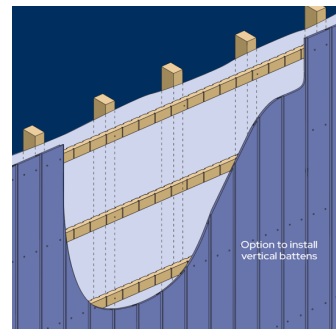

6. Install Vertical

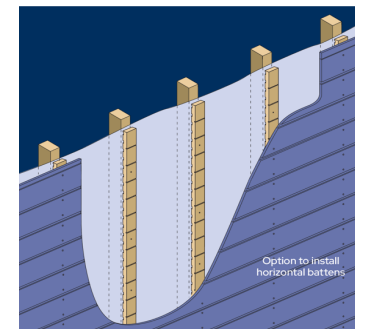

Selection Procedure:

1. Determine optimum batten spacing based on the type of cladding being used.
2. Check batten spacing chosen is within limits from the table above.
3. Determine fixings required based on batten spacing from the table above.

Span & Fixing Tables

1. Design Conditions			
Wind Classification	Design Wind Speed (m/s)	Stud Spacing (mm)	Max Structural Horizontal Ventbat™ Spacing (mm)
N1	34	450 / 600	1500
N2	40	450 / 600	1500
N3 / C1	50	450 / 600	1500
N4 / C2	50	450	1500
N5-N6 / C3-C4	86	450	900

Notes: Batten spacing and fixings allow for increased pressure near edges and corners. Alternative screws into timber frames must have countersunk head and be coated for durability. Machine driven 3.06Ø nails are suitable where 3.15Ø nails are noted in the table above. Timber frame minimum stud width to be 70mm. Maximum batten spacing is limited to 1500mm in tables.

2. Timber Frame Fixing								
Fastener Type	N1 450	N1 600	N2 450	N2 600	N3/C1 450	N3/C1 600	N4/C2 450	N5-N6/ C3-C4 450
2/3.15Ø × 75mm nails	1000	800	700	500	—	—	—	—
2/3.15Ø × 90mm nails	1500	1100	1100	800	700	500	—	—
1/10g × 65mm Type 17 screw	1500	1500	1500	1500	1100	1100	1000	500
2/10g × 65mm Type 17 screw	1500	1500	1500	1500	1500	1500	1500	900

3. Steel Frame Fixing (0.75 BMT)					
Fastener Type	N1/N2 450-600	N3/C1 450	N3/C1 600	N4/C2 450	N5-N6/ C3-C4 450
1/10g × 65mm Type 17 screw	1500	1100	1100	1000	500

